

How to load portal with MAG250

1. First please connect the to the Internet (USB WiFi or Ethernet)

"Settings"-->"System settings"-->"Network"

You can check the connection status in "Settings"-->"System settings"-->"Network info"

When "Link status:UP", connection succeeded.

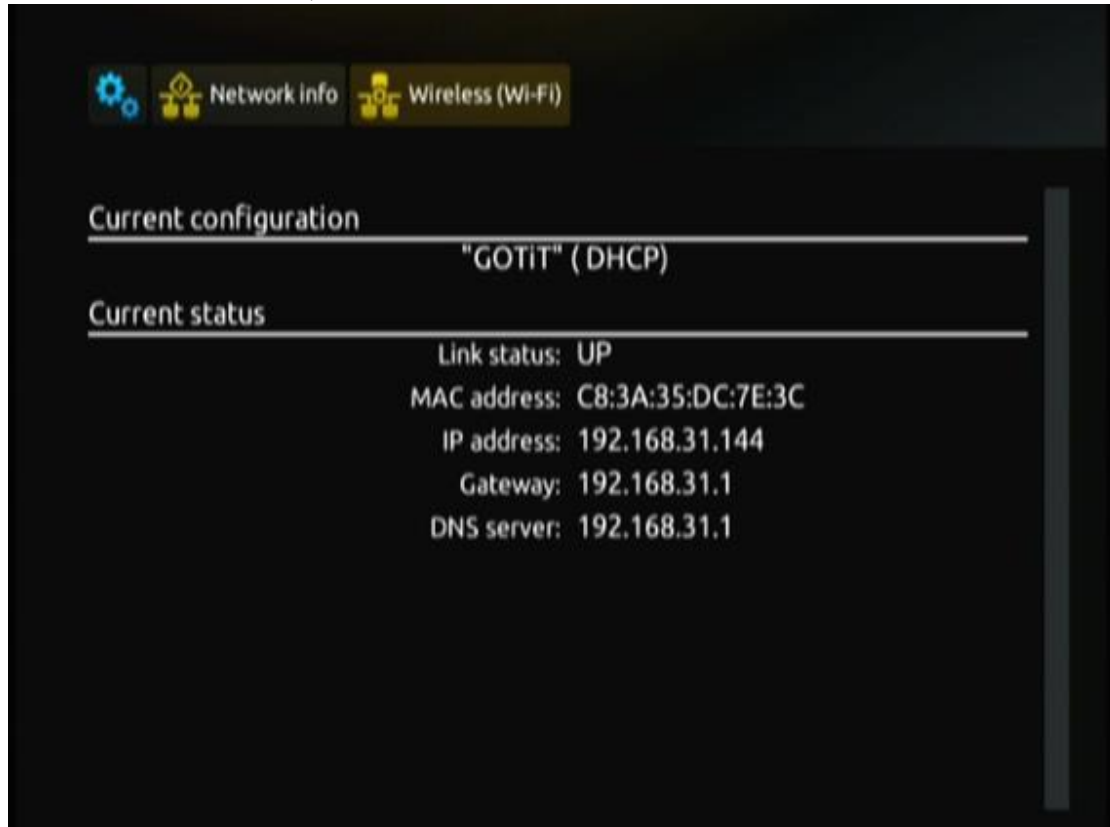

2. Load portal (For Royal IPTV/Super IPTV/Power IPTV)

"Settings"-->"System settings"-->"Server"-->"Portals"

For Royal IPTV, please type in as the following picture shows, then save.

The screenshot shows a dark-themed interface with a top navigation bar containing a gear icon, a server rack icon labeled 'Servers', and a server rack icon labeled 'Portals'. Below the navigation, there are four input fields. The first field is labeled 'Portal 1 name' and contains the text 'Royal IPTV'. The second field is labeled 'Portal 1 URL' and contains the text 'http://p.royaliptv.com/p/'. The third field is labeled 'Portal 2 name' and is empty. The fourth field is labeled 'Portal 2 URL' and is empty.

For Super IPTV, please type in as the following picture shows, then save.

The screenshot shows a dark-themed interface with a top navigation bar containing a gear icon, a server rack icon labeled 'Servers', and a server rack icon labeled 'Portals'. Below the navigation, there are four input fields. The first field is labeled 'Portal 1 name' and contains the text 'super iptv'. The second field is labeled 'Portal 1 URL' and contains the text 'http://lucky.lts1.net:23000/c'. The third field is labeled 'Portal 2 name' and is empty. The fourth field is labeled 'Portal 2 URL' and is empty.

For Power IPTV, please type in as the following picture shows, then save.

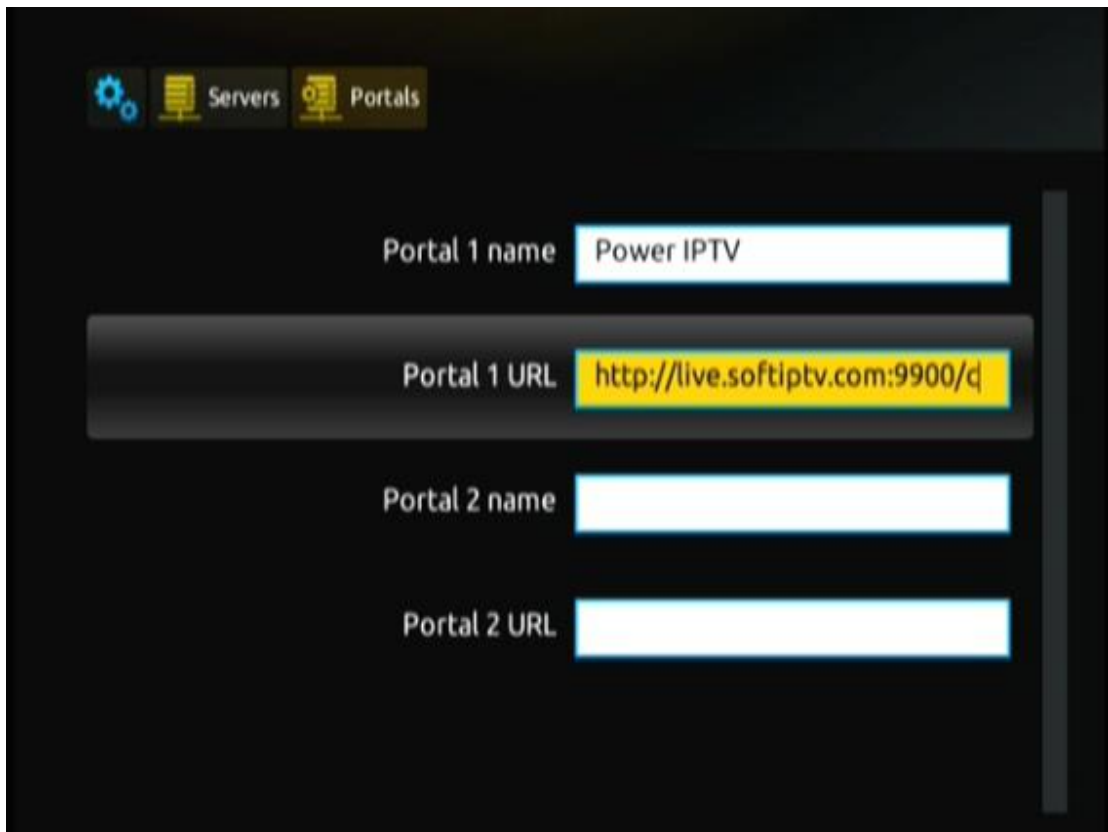

3.Restart portal

"Settings"-->"System settings"-->"Restart portal"

Then you will have the channels , in case of your MAG Address is activated.

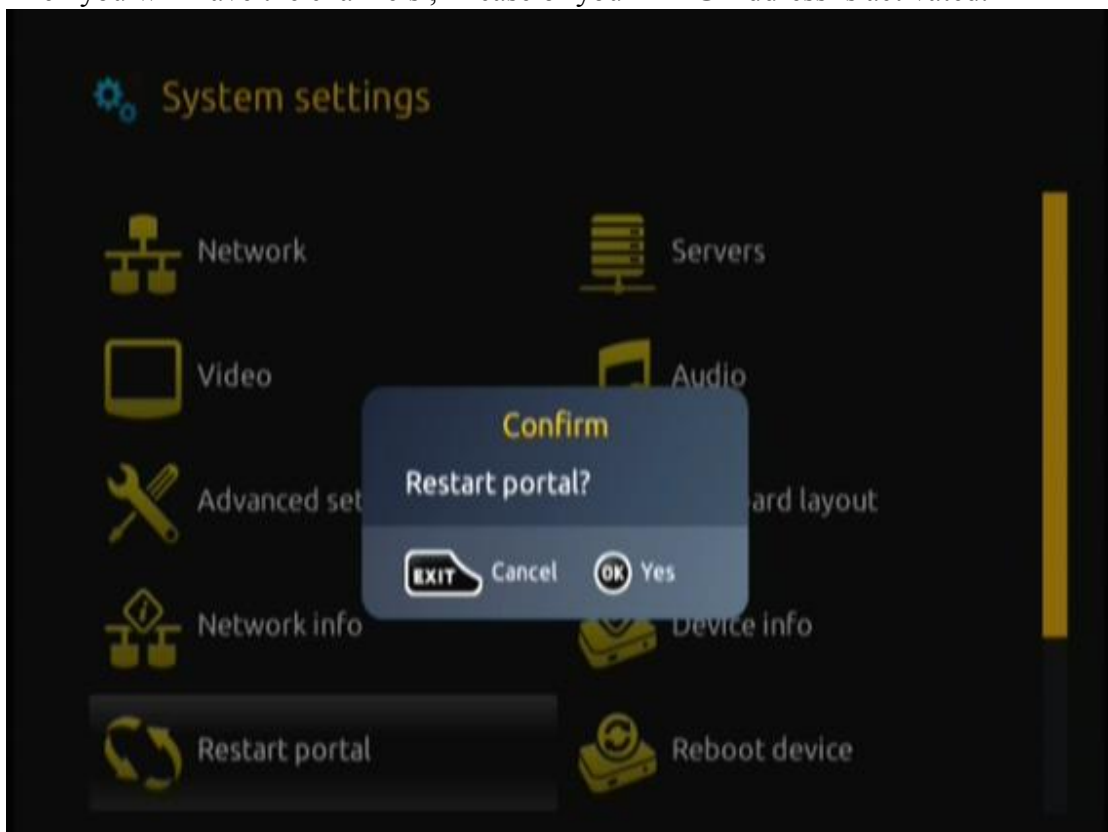

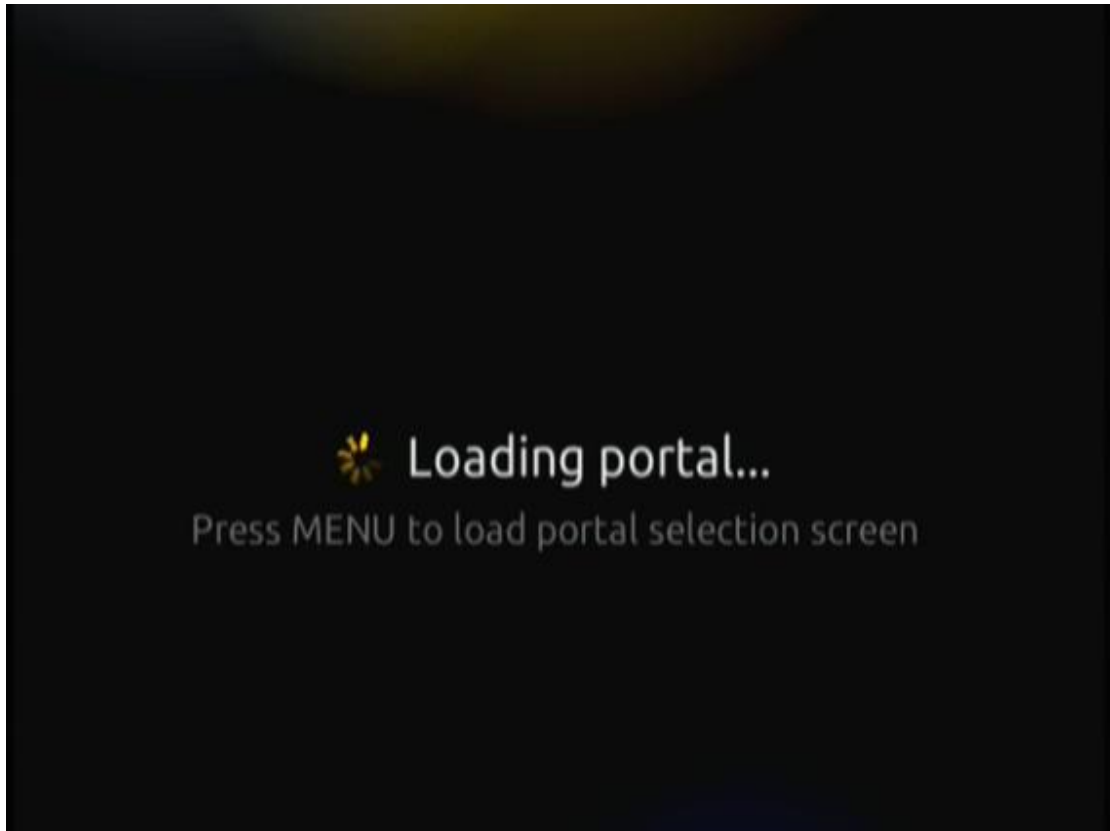

4.If your MAG Address is not activated yet, please go to the following interface have a check and tell me about it.

"Settings"-->"System settings"-->"Netwrok info"-->"Wired(Ethernet)"